



# 6016 NR Deep groove ball bearings

- SKF Explorer

## Deep groove ball bearings

### Bearing data

[Tolerances](#),

Normal (metric), P6, P5, Normal (inch),

[Radial internal clearance](#),

Matched bearing pairs, Stainless steel  
d < 10 mm, Other bearings

### Bearing interfaces

[Seat tolerances for standard conditions](#),

[Tolerances and resultant fits](#)

## Technical specification

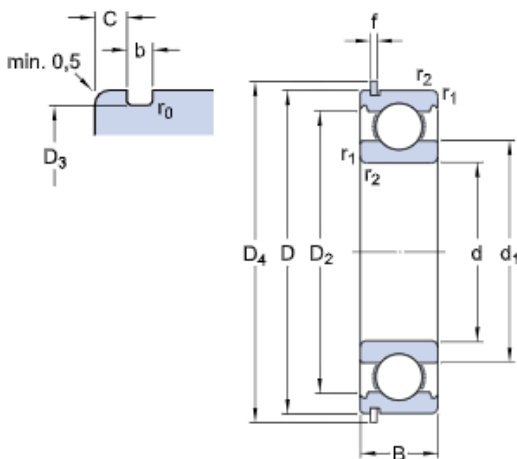

## DIMENSIONS

d	80 mm	Bore diameter
D	125 mm	Outside diameter
B	22 mm	Width
$d_1$	≈ 94.4 mm	Shoulder diameter
$D_2$	≈ 114.1 mm	Recess diameter
$D_3$	120.22 mm	Diameter of snap ring groove
$D_4$	134.7 mm	Outside diameter of snap ring
b	3.1 mm	Width of snap ring groove
C	2.87 mm	Distance outer ring from side face to snap ring groove
f	2.82 mm	Width of snap ring
$r_0$	max. 0.6 mm	Bottom radius of snap ring groove
$r_{1,2}$	min. 1.1 mm	Chamfer dimension

## ABUTMENT DIMENSIONS

$d_a$	min. 86 mm	Diameter of shaft abutment
$D_a$	max. 119 mm	Diameter of housing abutment
$D_b$	min. 136 mm	Diameter of snap ring recess in the housing

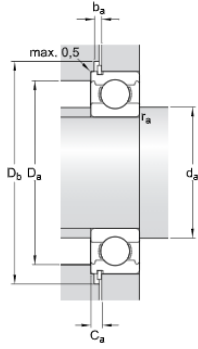

ba	min. 3.5 mm	Width of snap ring recess in the housing
Ca	max. 5.69 mm	Distance from outer ring side face to snap ring back face
ra	max. 1 mm	Radius of shaft or housing fillet

CALCULATION DATA

C	49.4 kN	Basic dynamic load rating
C <sub>0</sub>	40 kN	Basic static load rating
P <sub>u</sub>	1.66 kN	Fatigue load limit
	11 000 r/min	Reference speed
	7 000 r/min	Limiting speed
k <sub>r</sub>	0.025	Minimum load factor
f <sub>0</sub>	15.6	Calculation factor

MASS

	0.92 kg	Mass bearing
--	---------	--------------

INCLUDED PRODUCTS

SP 125	Snap ring
--------	-----------

TOLERANCE CLASS

P6	Dimensional tolerances
Normal	Radial run-out